

# Queen's Lake

Designed by Jocelyn Ueng of It's Sew Emma  
Featuring the Hennessy collection by Williamsburg for Windham Fabrics  
Finished Quilt Size: 71 ½" x 94"











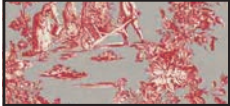

Always look on our website before starting your project to see  
if there are any updates or corrections.

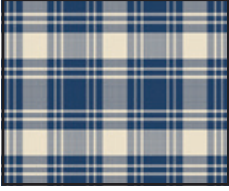
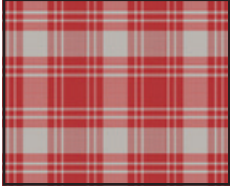
WINDHAM *W* FABRICS

812 Jersey Ave - Jersey City, NJ 07310 - 201.659.0444 - FAX: 201.659.9719  
[www.windhamfabrics.com](http://www.windhamfabrics.com) - email: [retail@windhamfabrics.com](mailto:retail@windhamfabrics.com)

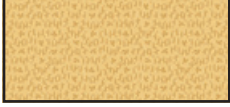
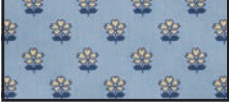
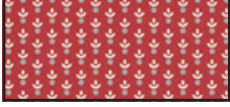
# Queen's Lake

Blue Quilt	Red Quilt	Yardage	Description	Quantity & Size		
25029 	25029 	3 ¼ yards	Background and Sashing	A	132	2 ⅞" squares
				B	48	4 ⅜" squares
				C	48	2 ½" x 14 ½" rectangles
37153-2 	37153-1 	¾ yard	Queen Blocks	D	6	10 ⅞" squares
37154-3 	37154-1 	¾ yard	Queen Blocks	E	6	10 ⅞" squares
37155-3 	37155-4 	3 ⅜ yards	Queen Blocks and Setting Triangles	F	66	2 ⅞" squares
				G	2	13 ⅝" squares
				H	3	26 ¾" squares
37158-2 	37156-4 	⅝ yard	Queen Blocks	I	66	2 ⅞" squares
37156-3 	37156-5 	1 ¼ yards	Pinwheel Blocks and Binding	J	24	4 ⅜" squares
				K	10	2 ½" x WOF strips
37159-2 	37158-4 	⅞ yard	Pinwheel Blocks and Cornerstones	L	24	4 ⅜" squares
				M	55	2 ½" squares
37160-2 	37160-1 	5 ⅞ yards	Backing			

# Queen's Lake

Use ¼" seams and press as arrows indicate throughout.

## Queen Blocks:

Draw a diagonal line on the wrong side of the Fabric D squares.

With right sides facing, layer a Fabric D square with a Fabric E square.

Stitch ¼" from each side of the drawn line.

Cut apart on the marked line.

Fabric D/E Half Square Triangle Unit should measure 10 ½" x 10 ½".

Repeat five more times.

Make 12.

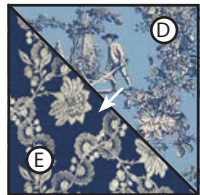
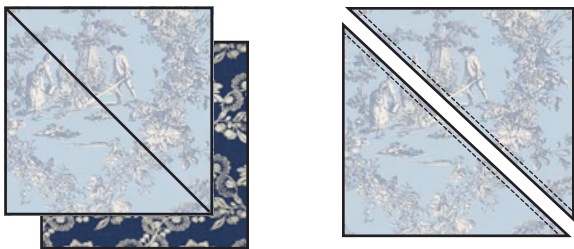

Make 12.

Draw a diagonal line on the wrong side of the Fabric A squares.

With right sides facing, layer a Fabric A square with a Fabric F square.

Stitch ¼" from each side of the drawn line.

Cut apart on the marked line.

Fabric A/F Half Square Triangle Unit should measure 2 ½" x 2 ½".

Repeat 65 more times.

Make 132.



With right sides facing, layer a Fabric A square with a Fabric I square.

Stitch ¼" from each side of the drawn line.

Cut apart on the marked line.

Fabric A/I Half Square Triangle Unit should measure 2 ½" x 2 ½".

Repeat 65 more times.

Make 132.



Assemble five Fabric A/F Half Square Triangle Units as shown.

Fabric A/F Half Square Triangle Strip should measure 2 ½" x 10 ½".

Repeat 11 more times.

Make 12.



Make 12.

Assemble five Fabric A/I Half Square Triangle Units as shown.

Fabric A/I Half Square Triangle Strip should measure 2 ½" x 10 ½".

Repeat 11 more times.

Make 12.



Make 12.

Assemble six Fabric A/F Half Square Triangle Units and one Fabric M square as shown.

Fabric A/F/M Half Square Triangle Strip should measure 2 ½" x 14 ½".

Repeat 11 more times.

Make 12.



Make 12.

# Queen's Lake

Assemble one Fabric M square and six Fabric A/I Half Square Triangle Units and as shown.

Fabric A/I/M Half Square Triangle Strip should measure  $2\frac{1}{2}" \times 14\frac{1}{2}"$ .

Repeat 11 more times.

Make 12.



Make 12.

Assemble one Fabric A/F Half Square Triangle Strip, one Fabric D/E Half Square Triangle Unit and one Fabric A/I Half Square Triangle Strip as shown.

Unit should measure  $10\frac{1}{2}" \times 14\frac{1}{2}"$ .

Repeat 11 more times.

Make 12.

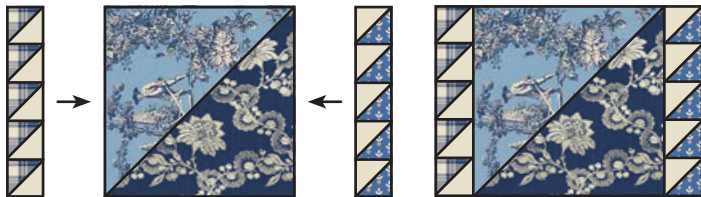

Make 12.

Assemble one Fabric A/F/M Half Square Triangle Strip, one unit from the previous step and one Fabric A/I/M Half Square Triangle Strip as shown.

Queen Block should measure  $14\frac{1}{2}" \times 14\frac{1}{2}"$ .

Repeat 11 more times.

Make 12.

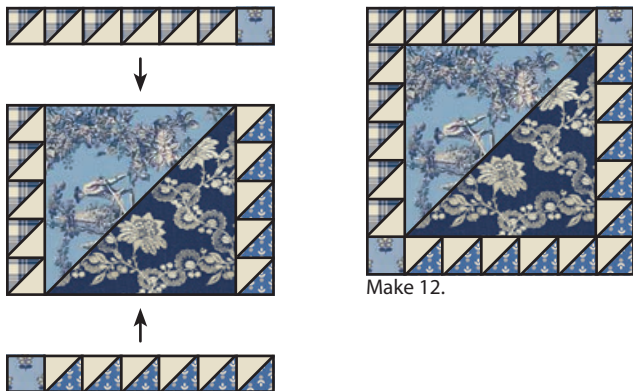

Make 12.

## Pinwheel Blocks:

Draw a diagonal line on the wrong side of the Fabric B squares.

With right sides facing, layer a Fabric B square with a Fabric L square.

Stitch  $\frac{1}{4}"$  from each side of the drawn line.

Cut apart on the marked line.

Fabric B/L Half Square Triangle Unit should measure  $4" \times 4"$ .

Repeat 23 more times.

Make 48.



With right sides facing, layer a Fabric B square with a Fabric J square.

Stitch  $\frac{1}{4}"$  from each side of the drawn line.

Cut apart on the marked line.

Fabric B/J Half Square Triangle Unit should measure  $4" \times 4"$ .

Repeat 23 more times.

Make 48.



Assemble two Fabric B/L Half Square Triangle Units as shown.

Fabric B/L Half Pinwheel Unit should measure  $4" \times 7\frac{1}{2}"$ .

Repeat 23 more times.

Make 24.



# Queen's Lake

Assemble two Fabric B/L Half Pinwheel Units as shown.  
Fabric B/L Pinwheel Unit should measure  $7\frac{1}{2}" \times 7\frac{1}{2}"$ .  
Repeat 11 more times.  
Make 12.

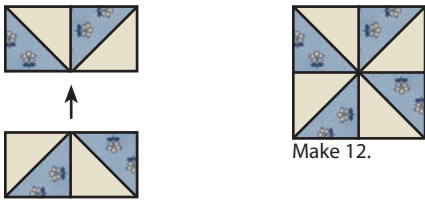

Assemble two Fabric B/J Half Square Triangle Units as shown.  
Fabric B/J Half Pinwheel Unit should measure  $4" \times 7\frac{1}{2}"$ .  
Repeat 23 more times.  
Make 24.



Assemble two Fabric B/J Half Pinwheel Units as shown.  
Fabric B/J Pinwheel Unit should measure  $7\frac{1}{2}" \times 7\frac{1}{2}"$ .  
Repeat 11 more times.  
Make 12.

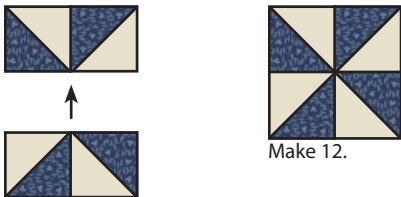

Assemble one Fabric B/L Pinwheel Unit and one Fabric B/J Pinwheel Unit as shown.  
Unit should measure  $7\frac{1}{2}" \times 14\frac{1}{2}"$ .  
Repeat 11 more times.  
Make 12.

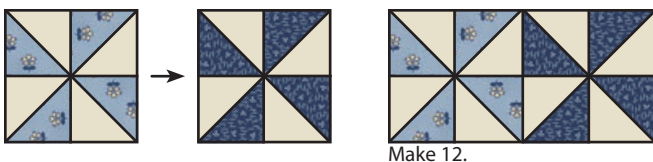

Assemble Pinwheel Block as shown.  
Unit should measure  $14\frac{1}{2}" \times 14\frac{1}{2}"$ .  
Repeat five more times.  
Make six.

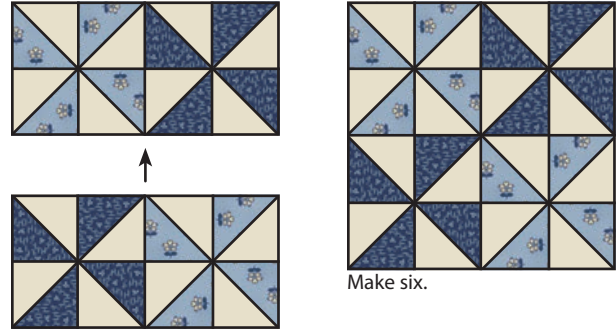

Assemble two Fabric C rectangles and one Queen Block as shown.  
Row One should measure  $14\frac{1}{2}" \times 18\frac{1}{2}"$ .  
Repeat one more time.  
Make two.

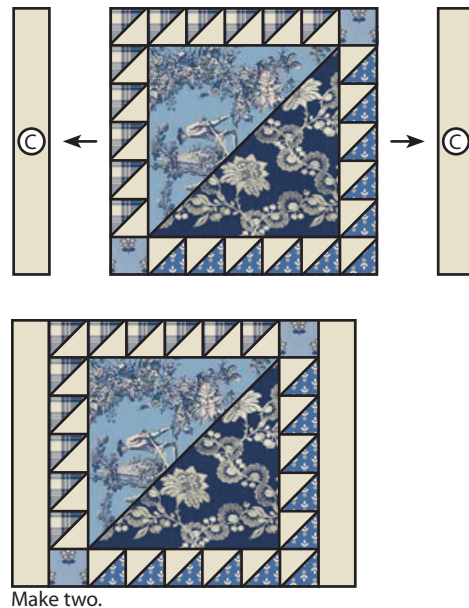

# Queen's Lake

Assemble four Fabric C rectangles, two Queen Blocks and one Pinwheel Block as shown.

Row Two should measure 14 ½" x 50 ½".

Repeat one more time.

Make two.

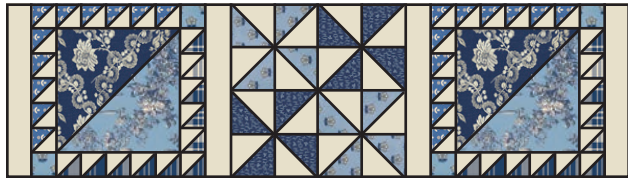
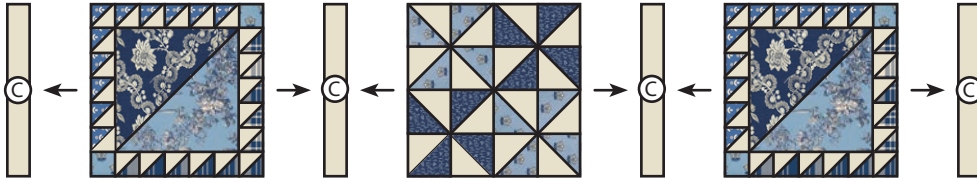

Make two.

Assemble six Fabric C rectangles, three Queen Blocks and two Pinwheel Blocks as shown.

Row Three should measure 14 ½" x 82 ½".

Repeat one more time.

Make two.

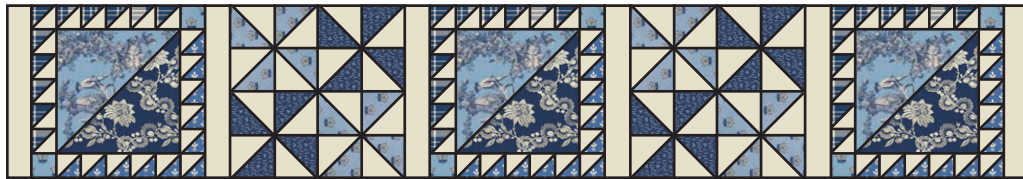
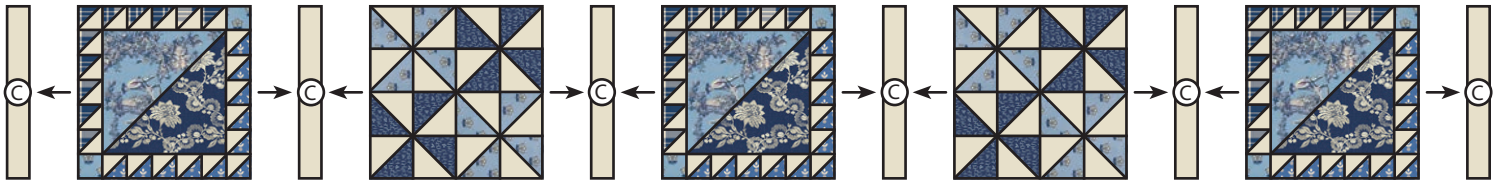

Make two.

Assemble two Fabric M squares and one Fabric C rectangle as shown.

One-Strip Sashing Unit should measure 2 ½" x 18 ½".

Repeat one more time.

Make two.

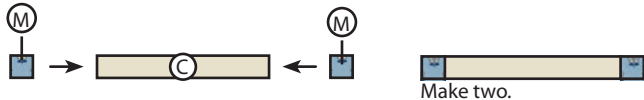

Make two.

Assemble four Fabric M squares and three Fabric C rectangles as shown.

Three-Strip Sashing Unit should measure 2 ½" x 50 ½".

Repeat one more time.

Make two.



Make two.

# Queen's Lake

Assemble six Fabric M squares and five Fabric C rectangles as shown.

Five-Strip Sashing Unit should measure  $2\frac{1}{2}" \times 82\frac{1}{2}"$ .

Repeat one more time.

Make two.

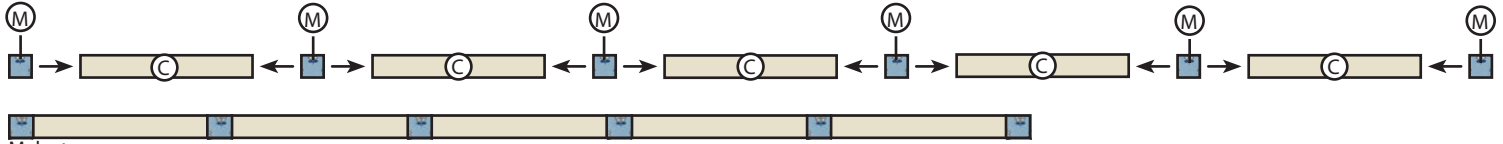

Make two.

Assemble seven Fabric M squares and six Fabric C rectangles as shown.

Six-Strip Sashing Unit should measure  $2\frac{1}{2}" \times 98\frac{1}{2}"$ .

Make one.

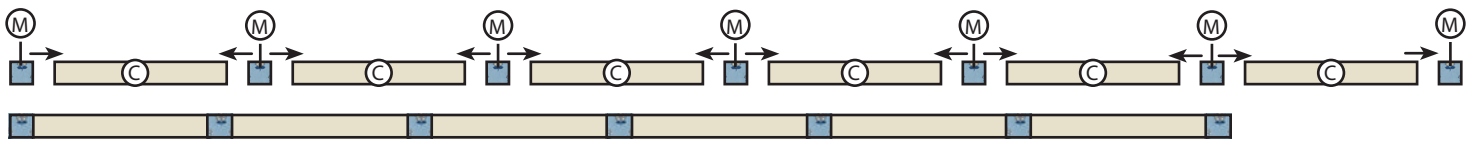

Make one.

Cut the Fabric G squares on the diagonal once



Make four.

Cut the Fabric H squares on the diagonal twice.

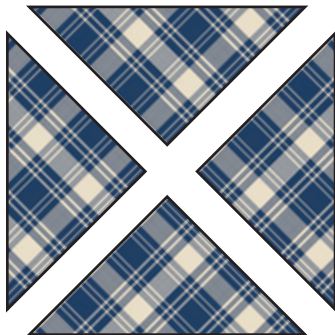

Make twelve.

Assemble one One-Strip Sashing Unit and one Row One as shown.

Repeat one more time.

Row One Unit should measure  $16\frac{1}{2}" \times 18\frac{1}{2}"$ .

Make two.

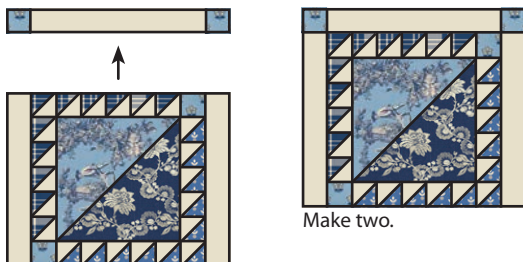

Make two.

# Queen's Lake

Assemble two Fabric H triangles and one Row One as shown.

Repeat one more time.

Make two.

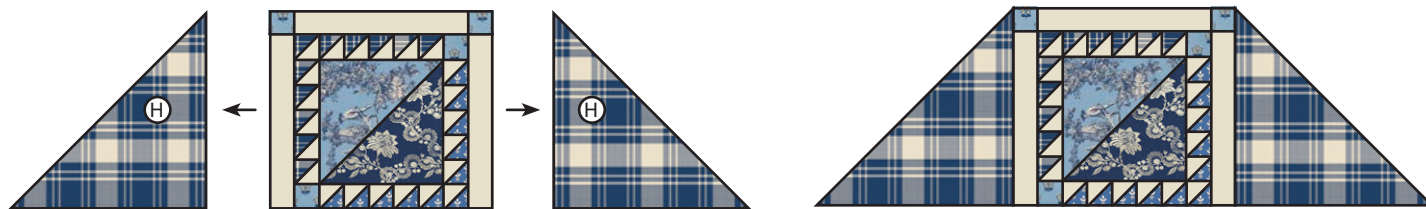

Assemble one Three-Strip Sashing Unit and one Row Two as shown.

Repeat one more time.

Row Two Unit should measure 16 1/2" x 50 1/2".

Make two.

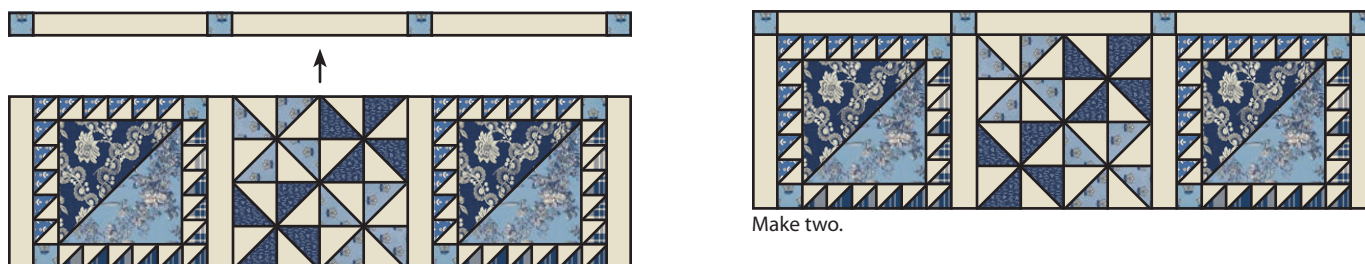

Assemble two Fabric H rectangles and one Row Two as shown.

Repeat one more time.

Make two.

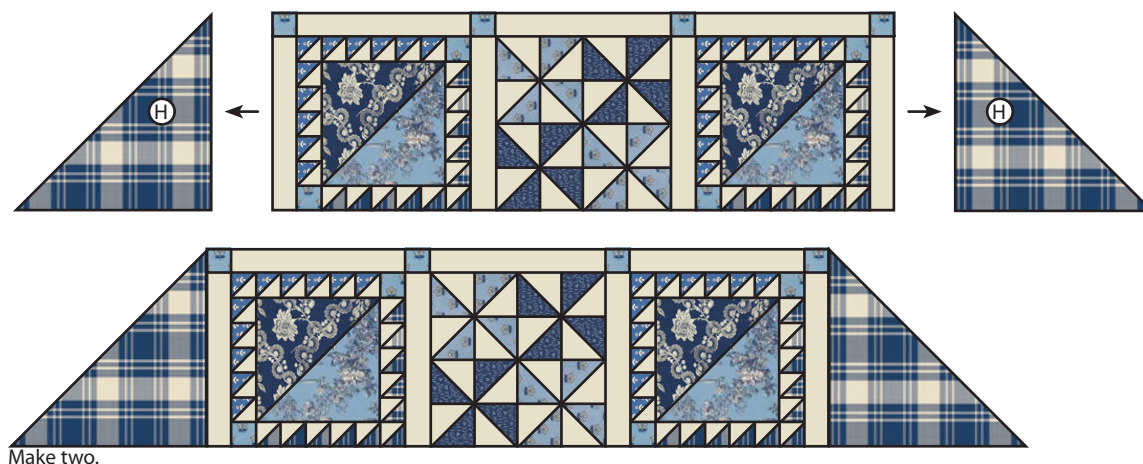

# Queen's Lake

Assemble one Five-Strip Sashing Unit and one Row Three as shown.

Repeat one more time.

Unit should measure 18 ½" x 82 ½".

Make two.

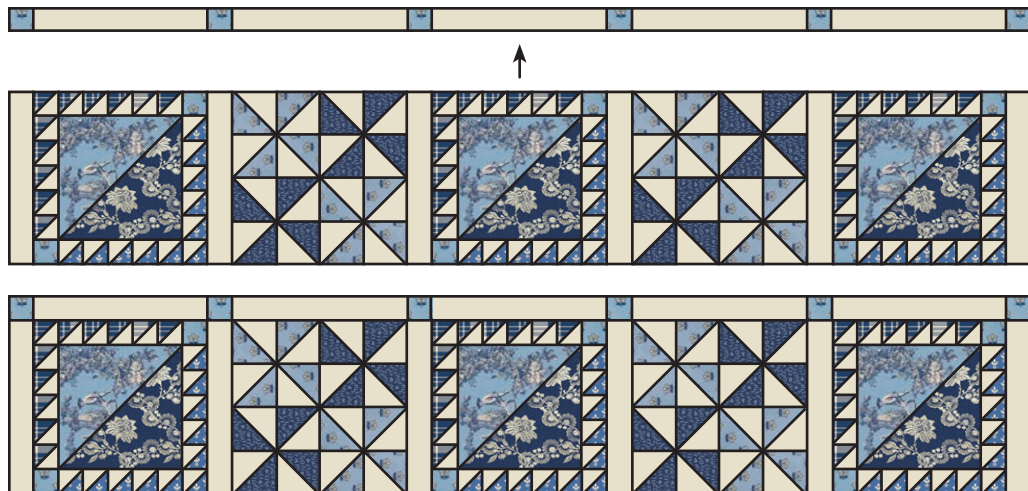

Make two.

---

Assemble one Fabric H triangle and one Row Three Unit as shown.

Repeat one more time.

Make two.

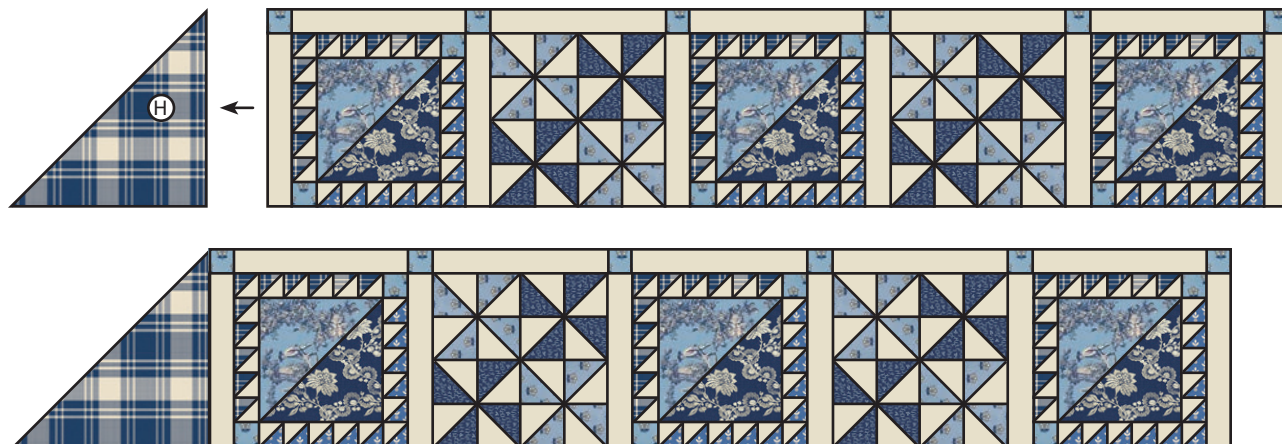

Make two.

# Queen's Lake

Assemble rows as shown.  
Repeat one more time.  
Make two Quilt Center halves.

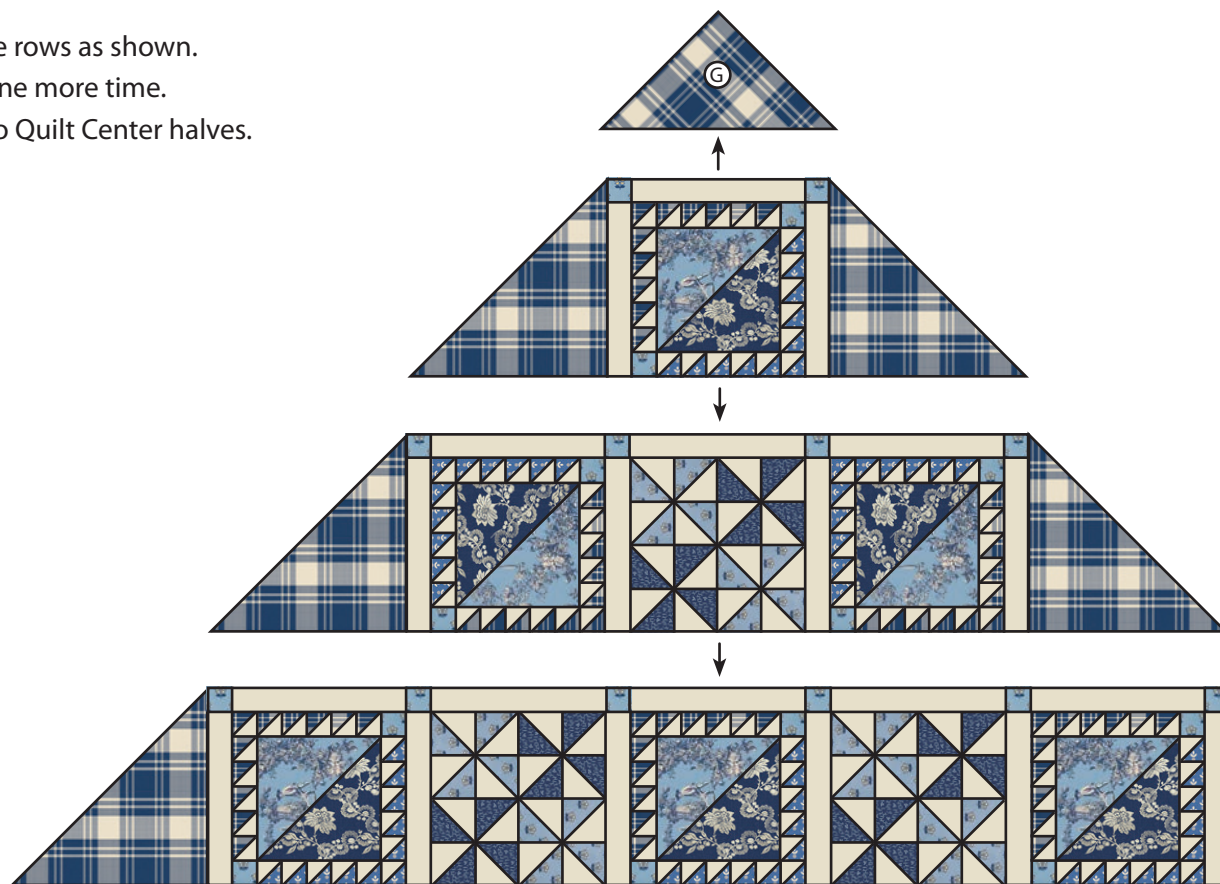

Assemble one Quilt Center half and one Six-Strip Sashing Unit as shown. Then attach one Fabric G triangle as shown.  
Make one.

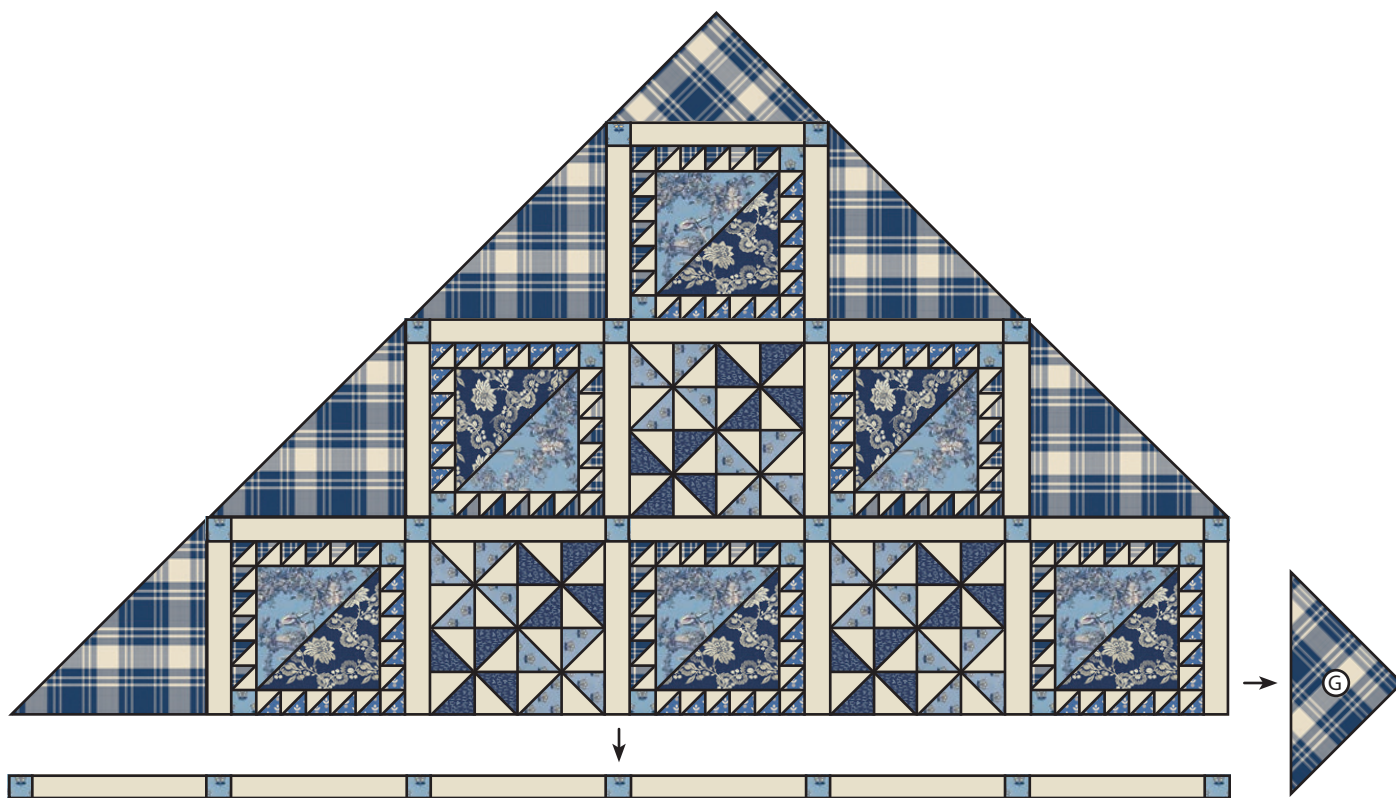

# Queen's Lake

Assemble Quilt Center as shown and attach one Fabric G triangle as shown.



# Queen's Lake

## Finishing:

Piece Fabric K strips end to end for binding.

Quilt and bind as desired.

