

# Cascade

Designed by Jocelyn Ueng for It's Sew Emma  
Featuring the Mormor collection by Lotta Jansdotter for Windham Fabrics  
Finished Quilt Size: 66 ½" x 78 ½"



**Always look on our website before starting your project to see  
if there are any updates or corrections.**









**WINDHAM *W* FABRICS**

812 Jersey Ave - Jersey City, NJ 07310 - 201.659.0444 - FAX: 201.659.9719  
www.windhamfabrics.com - email: retail@windhamfabrics.com

# Cascade

Fabric Image	SKU	Yardage	Description	Quantity & Size		
	31835	3 ¾ yard	Background	A	60	4 ⅞" squares
				B	136	4 ½" squares
				C	14	4 ½" squares
	37116-1	Fat Quarter	Blocks	D1	3	4 ⅞" squares
				E1	4	4 ½" x 8 ½" rectangles
	37116-2	Fat Quarter	Blocks	D2	3	4 ⅞" squares
				E2	4	4 ½" x 8 ½" rectangles
	37116-3	Fat Quarter + ⅞ yard	Blocks & Binding	D3	3	4 ⅞" squares
				E3	4	4 ½" x 8 ½" rectangles
				G	9	2 ½" x WOF strips (binding)
	37116-4	Fat Quarter	Blocks	D4	3	4 ⅞" squares
				E4	4	4 ½" x 8 ½" rectangles
	37117-1	Fat Quarter	Blocks	D5	3	4 ⅞" squares
				E5	4	4 ½" x 8 ½" rectangles
	37117-3	Fat Quarter	Blocks	D6	3	4 ⅞" squares
				E6	4	4 ½" x 8 ½" rectangles
	37117-5	Fat Quarter	Blocks	D7	3	4 ⅞" squares
				E7	4	4 ½" x 8 ½" rectangles
	37118-5	Fat Quarter	Blocks	D8	3	4 ⅞" squares
				E8	4	4 ½" x 8 ½" rectangles
	37118-6	Fat Quarter	Blocks	D9	3	4 ⅞" squares
				E9	4	4 ½" x 8 ½" rectangles
	37118-7	Fat Quarter	Blocks	D10	3	4 ⅞" squares
				E10	4	4 ½" x 8 ½" rectangles
	37119-6	Fat Quarter	Blocks	D11	3	4 ⅞" squares
				E11	4	4 ½" x 8 ½" rectangles
	37119-7	Fat Quarter	Blocks	D12	3	4 ⅞" squares
				E12	4	4 ½" x 8 ½" rectangles

# Cascade

Fabric Image	SKU	Yardage	Description	Quantity & Size		
	37119-9	Fat Quarter	Blocks	D13	3	4 7/8" squares
				E13	4	4 1/2" x 8 1/2" rectangles
	37119-10	Fat Quarter	Blocks	D14	3	4 7/8" squares
				E14	4	4 1/2" x 8 1/2" rectangles
	37121-4	Fat Quarter	Blocks	D15	3	4 7/8" squares
				E15	4	4 1/2" x 8 1/2" rectangles
	37121-9	Fat Quarter	Blocks	D16	3	4 7/8" squares
				E16	4	4 1/2" x 8 1/2" rectangles
	37121-10	Fat Quarter	Blocks	D17	3	4 7/8" squares
				E17	4	4 1/2" x 8 1/2" rectangles
	37122-2	Fat Quarter	Blocks	D18	3	4 7/8" squares
				E18	4	4 1/2" x 8 1/2" rectangles
	37122-3	Fat Quarter	Blocks	D19	3	4 7/8" squares
				E19	4	4 1/2" x 8 1/2" rectangles
	37122-9	Fat Quarter	Blocks	D20	3	4 7/8" squares
				E20	4	4 1/2" x 8 1/2" rectangles
	37120-6	1 yard	Outer Border	F	8	3 1/2" x WOF strips
	Fabric of Choice	5 yards	Backing			

# Cascade

Use  $\frac{1}{4}$ " seams and press as arrows indicate throughout.  
Mix and match fabrics for Fabric D squares and Fabric E rectangles as desired.

## Block Assembly:

Draw a diagonal line on the wrong side of the Fabric A squares.

With right sides facing, layer a Fabric A square with a Fabric D square.

Stitch  $\frac{1}{4}$ " from each side of the drawn line.

Cut apart on the marked line.

Half Square Triangle Unit should measure  $4\frac{1}{2}$ " x  $4\frac{1}{2}$ ".

Repeat 59 more times.

Make 120.

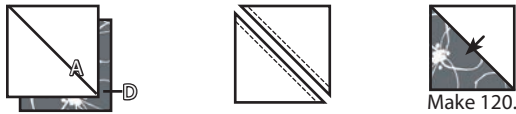

Draw a diagonal line on the wrong side of the Fabric B squares.

With right sides facing, layer a Fabric B square on the left end of a Fabric E rectangle.

Stitch on the drawn line and trim  $\frac{1}{4}$ " away from the seam.

Repeat on the right end of the Fabric E rectangle.

Rectangle One Unit should measure  $4\frac{1}{2}$ " x  $8\frac{1}{2}$ ".

Repeat 39 more times.

Make 40.



With right sides facing, layer a Fabric B square on the left end of a Fabric E rectangle.

Stitch on the drawn line and trim  $\frac{1}{4}$ " away from the seam.

Repeat on the right end of the Fabric E rectangle.

Rectangle Two Unit should measure  $4\frac{1}{2}$ " x  $8\frac{1}{2}$ ".

Repeat 27 more times.

Make 28.

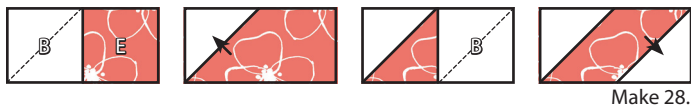

You will not use all of the Fabric E rectangles.

Assemble one Rectangle One Unit and one Half Square Triangle Unit as shown.

Block A Unit should measure  $4\frac{1}{2}$ " x  $12\frac{1}{2}$ ".

Repeat 39 more times.

Make 40.



Assemble one Half Square Triangle Unit and one Fabric Rectangle Two Unit as shown.

Block B Unit should measure  $4\frac{1}{2}$ " x  $12\frac{1}{2}$ ".

Repeat 27 more times.

Make 28.



Assemble two Block A Units and one Block B Unit as shown.

Block One should measure  $12\frac{1}{2}$ " x  $12\frac{1}{2}$ ".

Repeat eight more times.

Make nine.

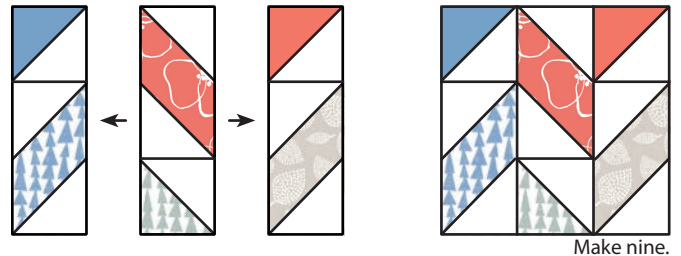

Assemble two Block B Units and one Block A Unit as shown.

Block Two should measure  $12\frac{1}{2}$ " x  $12\frac{1}{2}$ ".

Repeat five more times.

Make six.

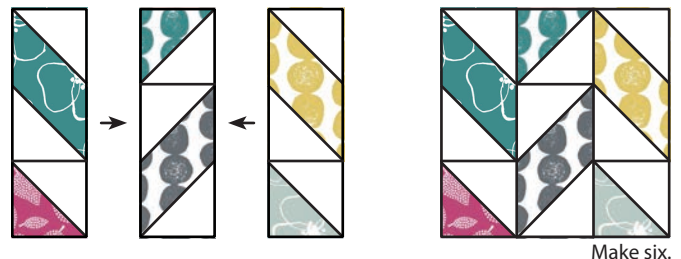



# Cascade

Assemble one Half Square Triangle Unit and one Fabric C square as shown.

Block C Unit should measure  $4\frac{1}{2}" \times 8\frac{1}{2}"$ .

Repeat six more times.

Make seven.

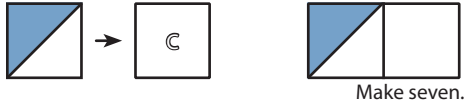

Assemble two Rectangle One Units and one Block C Unit as shown.

Block Three should measure  $8\frac{1}{2}" \times 12\frac{1}{2}"$ .

Repeat two more times.

Make three.

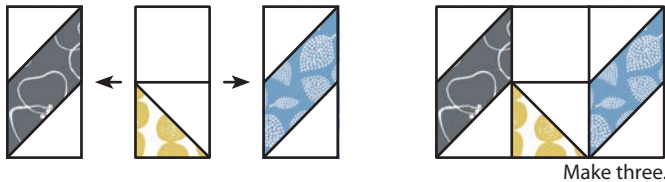

Assemble two Block C Units and one Rectangle One Unit as shown.

Block Four should measure  $8\frac{1}{2}" \times 12\frac{1}{2}"$ .

Repeat one more time.

Make two.

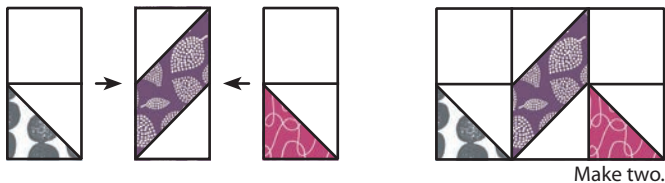

Assemble one Fabric C square and one Rectangle Two Unit as shown.

Block D Unit should measure  $4\frac{1}{2}" \times 12\frac{1}{2}"$ .

Repeat six more times.

Make seven.



Assemble two Block A Units and one Block D Unit as shown.

Block Five should measure  $12\frac{1}{2}" \times 12\frac{1}{2}"$ .

Repeat two more times.

Make three.

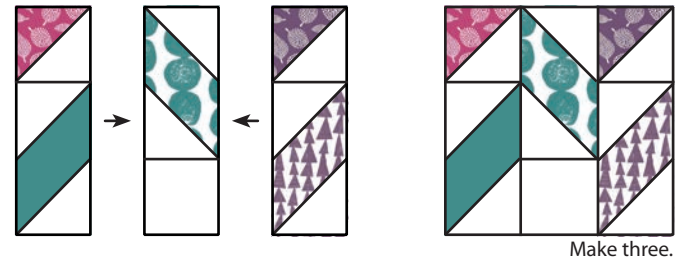

Assemble two Block D Units and one Block A Unit as shown.

Block Six should measure  $12\frac{1}{2}" \times 12\frac{1}{2}"$ .

Repeat one more time.

Make two.

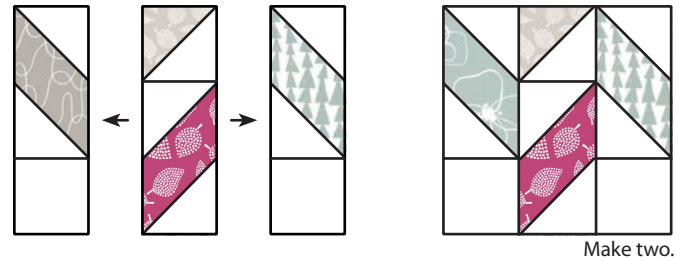

Assemble fifteen Fabric A/D Half Square Triangle Units as shown.

Sashing Strip should measure  $4\frac{1}{2}" \times 60\frac{1}{2}"$ .

Repeat three more times.

Make four.

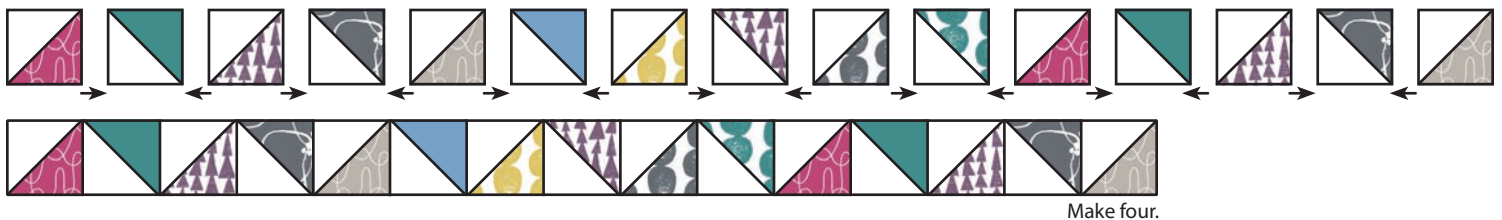

# Cascade

Assemble three Block Threes and two Block Fours as shown.

Row One should measure 8 ½" x 60 ½".

Make one.

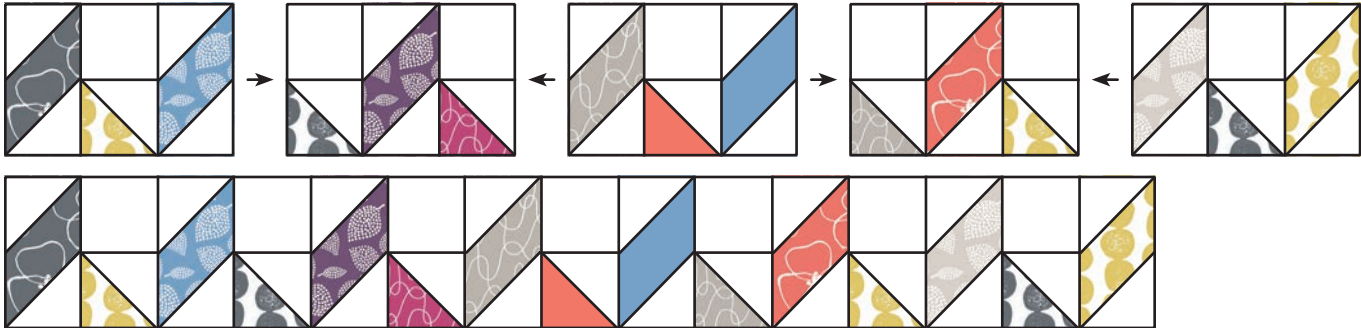

Make one.

Assemble three Block Ones and two Block Twos as shown.

Row Two should measure 12 ½" x 60 ½".

Repeat two more times.

Make three.

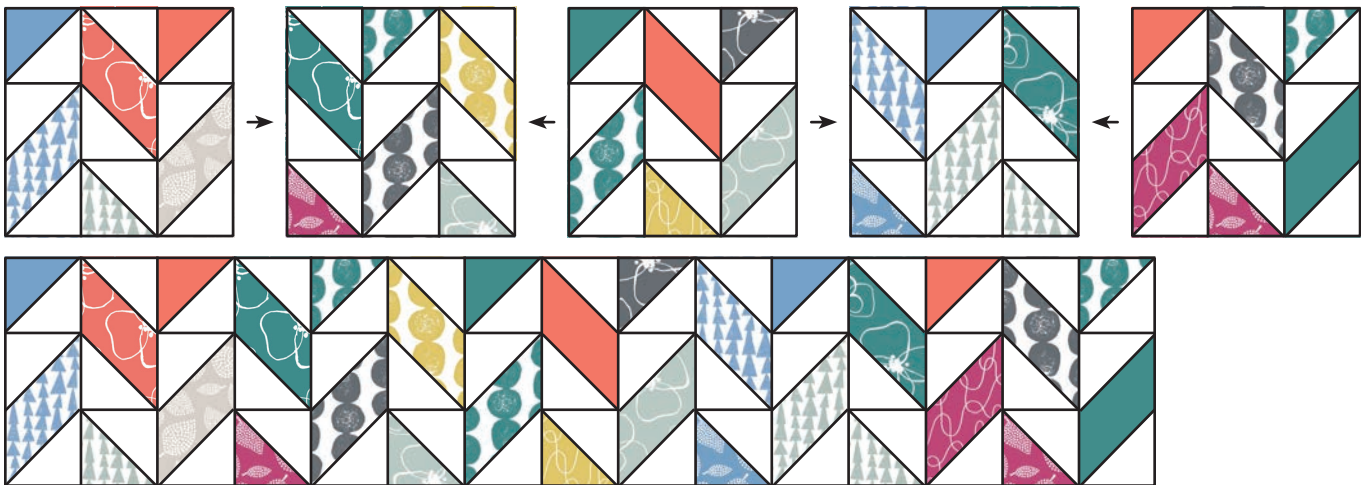

Make three.

Assemble three Block Fives and two Block Sixes as shown.

Row Three should measure 12 ½" x 60 ½".

Make one.

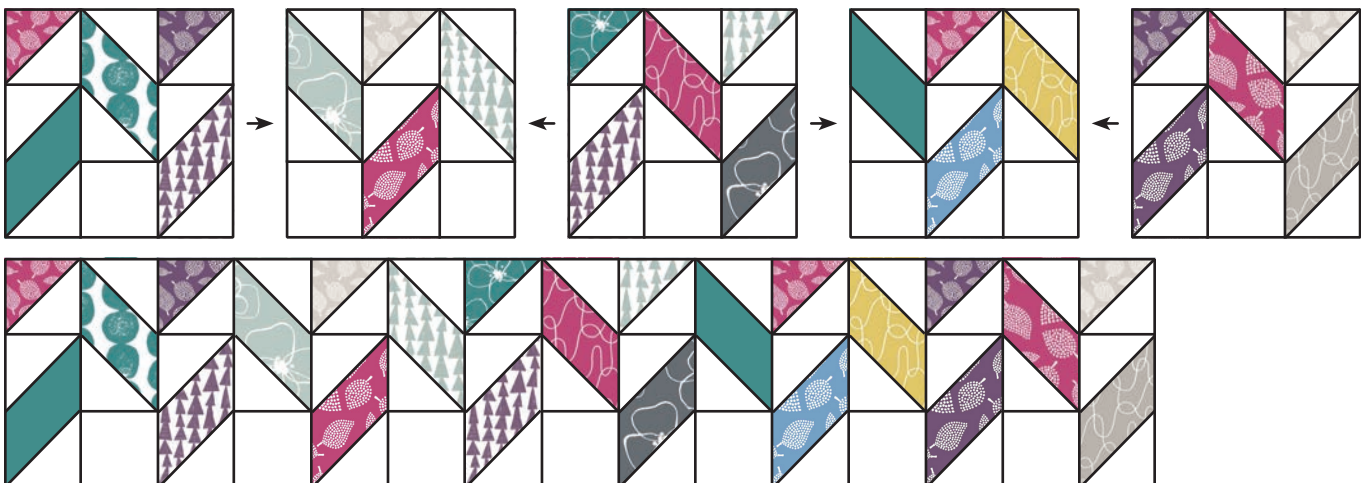

Make one.

# Cascade

Assemble one Row One, four Sashing Strips, three Row Twos and one Row Three as shown.  
Quilt Center should measure 60 ½" x 72 ½".

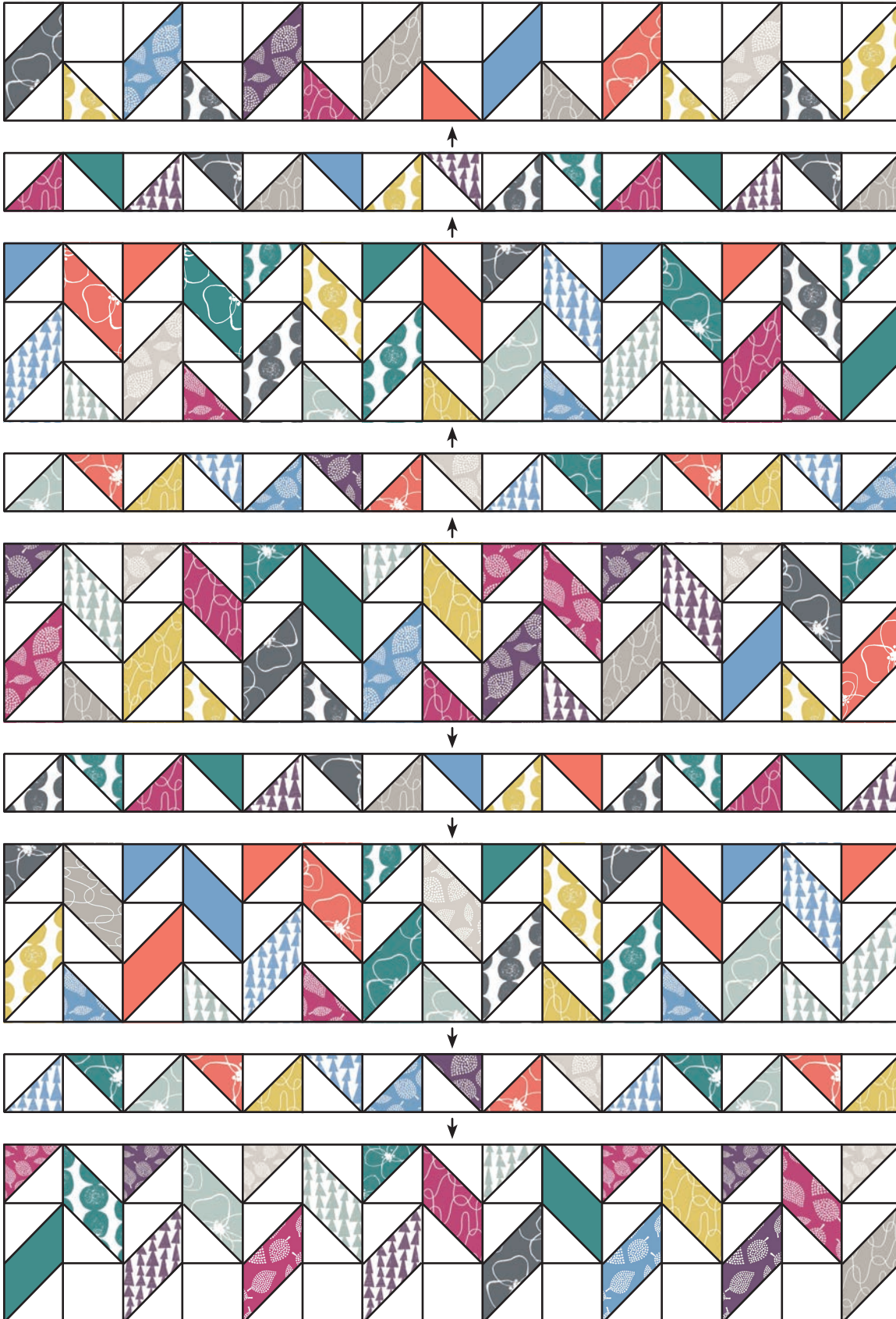



# Cascade

Piece Fabric F strips end to end and subcut into:

2 - 3 1/2" x 72 1/2" strips (F1).

2 - 3 1/2" x 66 1/2" strips (F2).

Attach side borders using Fabric F1 strips.

Attach top and bottom borders using Fabric F2 strips.

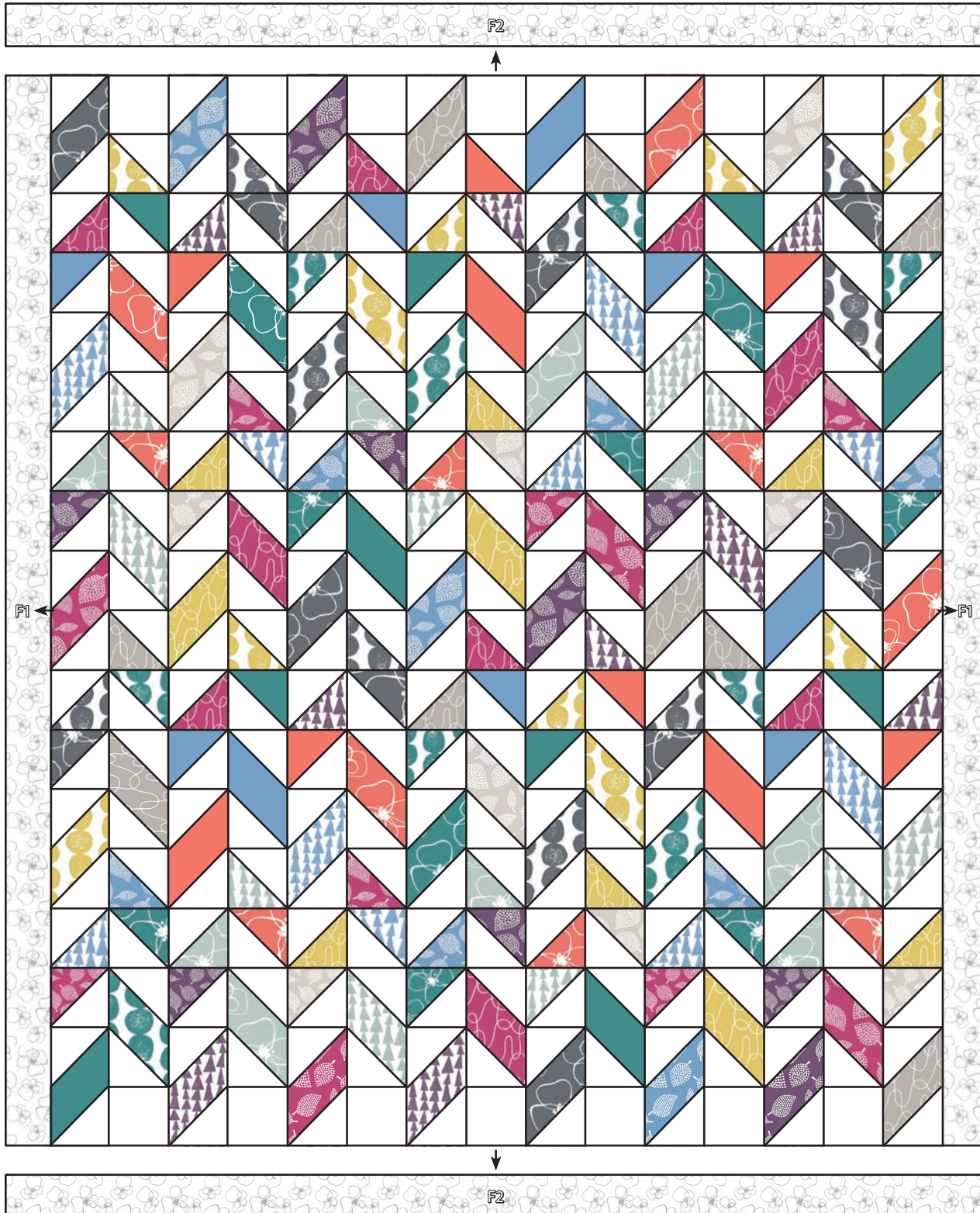



# Cascade

## Finishing:

Piece Fabric G strips end to end for binding.

Quilt and bind as desired.

